

TECHNICAL SPECIFICATIONS

ANCHORSPEEDY

The ANCHORSPEEDY by Palmer Safety is an anchorage connector that can be conveniently disposed of after use. It is specially designed to fit a range of wood roof pitches and meets all relevant OSHA regulations. Installing and removing the ANCHORSPEEDY is easy and hassle-free. Simply adjust it to fit over the roof ridge of your choice and use all the installation holes to nail it into the roof truss.

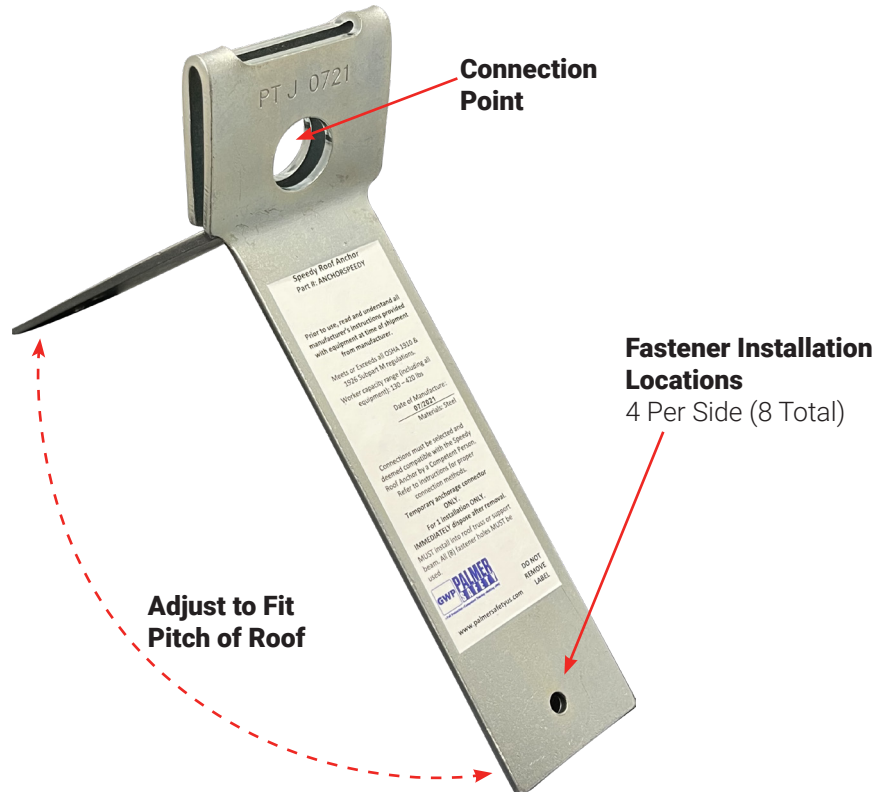

CAPACITY: 1 user: 130 – 420 lbs. (including all clothing, tools, and equipment)

DESIGN:

- Lightweight and durable
- Easy to Install
- Length: 16"
- One-time use only. Must be disposed of after one installation.

MATERIAL: Steel

MINIMUM SUBSTRATE THICKNESS REQUIREMENTS: Wood: 3½" (must include truss or other equivalent structural support beam). Do not install on any other substrate material.

COMPATIBLE ROOF PITCH:

- Installed over roof peak: 0/12 - 12/12.
- Installed on flat surface: 0/12 - vertical/sheer. Never install past sheer (such as on underside of beam or slab).

FASTENER REQUIREMENTS: 16d nails (qty. 8). Do not install with fasteners other than nails.

CONFORM TO NORM: Meets or Exceeds OSHA 1910.140, OSHA 1926.502

WEIGHT 1 lbs.