

PN: A00001

## TECHNICAL SPECIFICATIONS

### Single Point Steel Anchor

Single Point Steel Anchor. Galvanized Steel. Min breaking strength 5000 lbs. Conforms to ANSI Z359.1-2007.

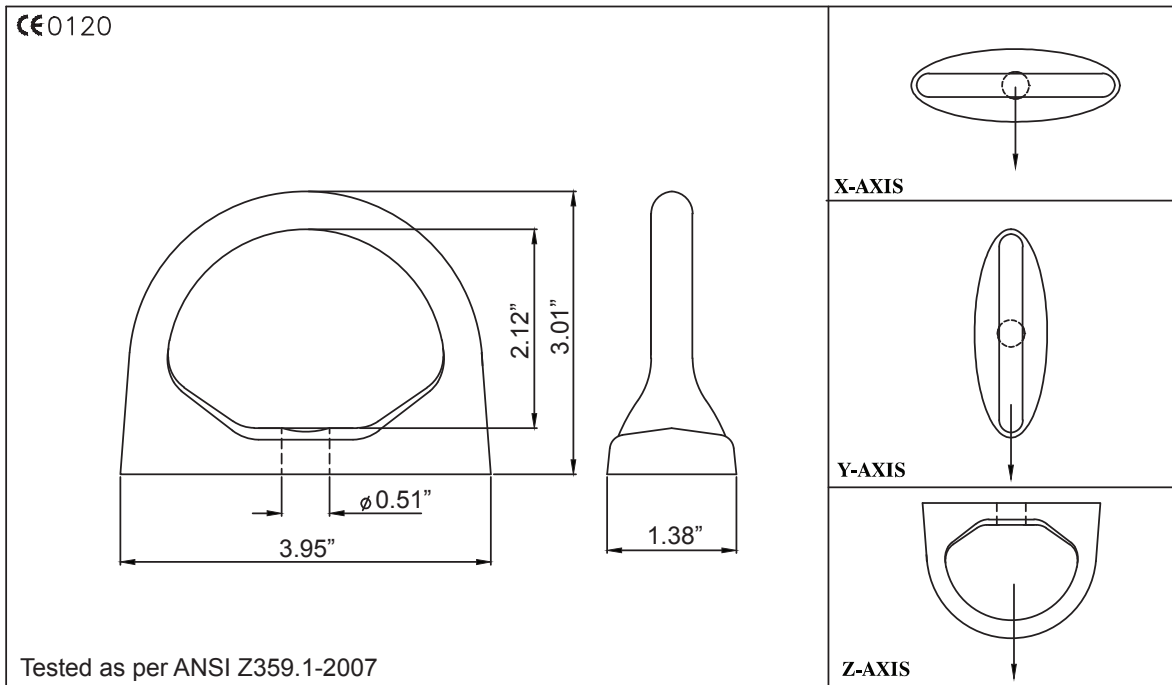

- DESIGN:**
- Single point anchor is designed to be fixed on walls, ceilings, roof tops or steel structures.
  - It can be used to sustain the load impact in all three axes (X, Y, & Z).
  - Alloy Steel

**FINISH:** Yellow Chromate

**MINIMUM BREAKING STRENGTH:** X Axis: 23 kN (min) | Y Axis: 23 kN (min) | Z Axis: 23 kN (min)

**CONFORM TO NORM:** Meets or exceeds ANSI Z359.1-2007.

**WEIGHT:** 0.84 lbs.  $\pm$  0.02 lbs.